

Conjunction Box

Installation V1.0

1. Attach conjunction box to the installation area
2. Drill holes on wall
3. Punch the concrete anchors to the holes (2)
4. Tear off the adhesive tape from the water-resist spacer and attach to the conjunction box according to the hole's locations.

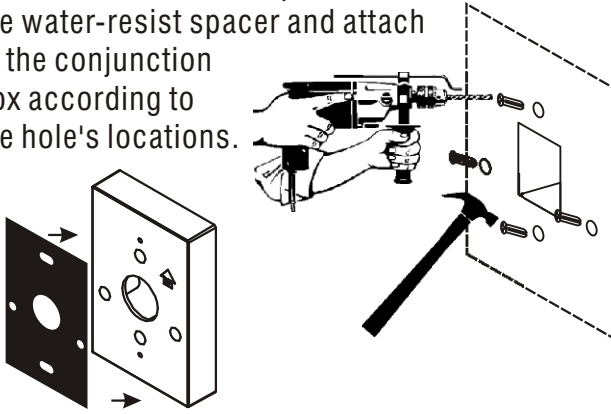

12. Connect bus wires to the pin socket on the main board of the face cover
13. Push unused cables back to the conjunction box.

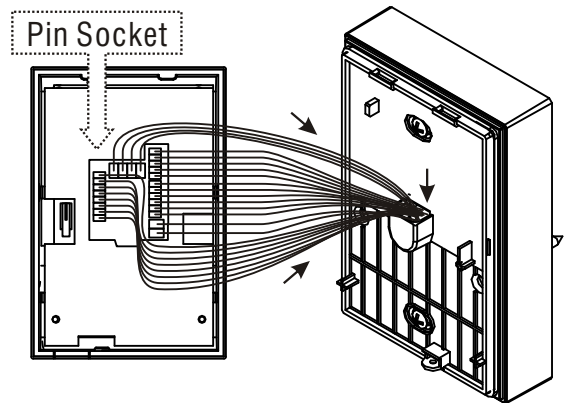

5. Thread the wires thru the cut-out opening on conjunction box.
6. Fasten the conjunction box on the wall.

Note:

Two sealed holes reserved for any Top or Bottom wire deployment requirement.

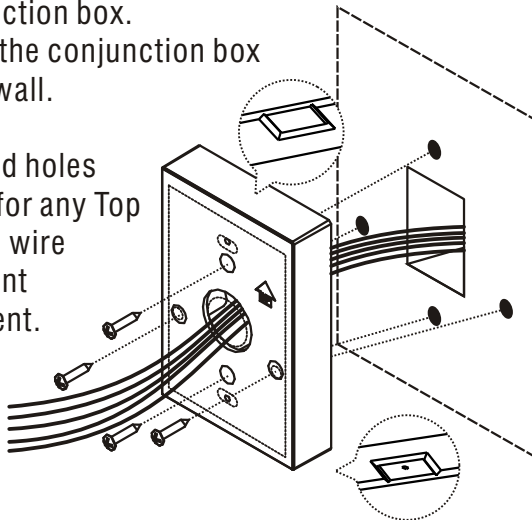

14. Assembly rear and face covers then fasten screws beneath the case
15. Finished

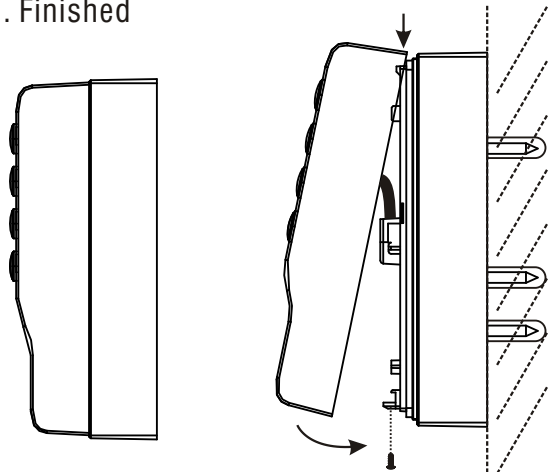

7. Thread the wires thru the cut-out opening.
8. Fasten the conjunction box.
9. Thread the bus wires thru the rear cover
10. Push the unused wires back to the conjunction box.
11. Fasten the rear cover with conjunction box.

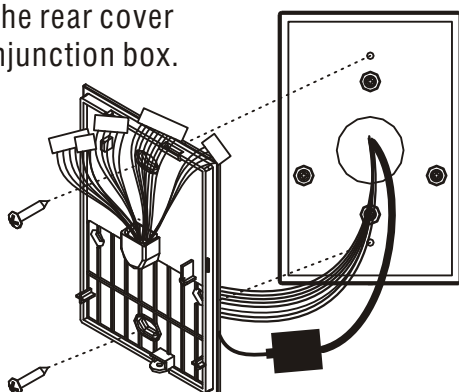

Note:

Using silicone around the conjunction box and the wall is recommended to prevent moisture from the circuit.

